



# Installation Instructions

Thank you for purchasing this anti-sway bar kit. Please read through these instructions before installation.

## Rear Anti-Sway Bar Kit for Freightliner FL60

part #1209-101  
1-1/2" diameter

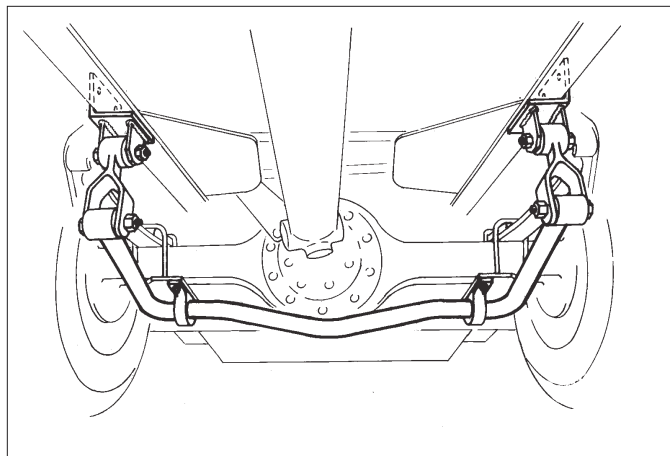

## INTRODUCTION

Thank you for purchasing this anti-sway bar kit. This kit is designed to improve the handling characteristics of your Freightliner FL60 by reducing the body roll and balancing the weight transfer during cornering. The anti-sway bar kit is engineered for long life and trouble-free performance. For maximum suspension control, use this kit along with our front anti-sway bar kit.

All the hardware needed for installation is included in this kit. Refer to the PARTS LIST in these instructions to identify the parts.

## SUGGESTED TOOLS

The following tools are suggested to complete the installation procedures:

- General hand tools
- Sockets: 5/8", 11/16", 3/4", 15/16"
- Torque wrench
- Wrenches: 5/8", 11/16", 3/4", 15/16"

## WARNING

- If raising the vehicle to install the anti-sway bar, always support the vehicle with jack stands at both frame rails or at the rear axle before working underneath. Ensure that the jack stands are securely positioned, and are rated at or above the weight of the vehicle.
- The installer must read the instructions and use all bolts and parts supplied. Use only the parts supplied by ROADMASTER to install this kit.
- Minor modifications are sometimes necessary due to slight vehicle variations, even for the same year, make and model.
- If running changes were made by the manufacturer after this kit was designed, there may be weldments, braces, gussets, or other structural items which interfere with the installation. It is the installer's responsibility to allow for these running changes without sacrificing the structural integrity of the anti-sway bar. Failure to securely fasten the anti-sway bar could result in property damage, personal injury or even death.
- ROADMASTER will not be responsible for any damage or injury resulting from any modification or alteration.
- Check ALL the fasteners for tightness before and after road testing the vehicle.
- Do not use this document for custom fabrication, as it may not show all parts or structural components.
- Do not use an air impact wrench when re-installing bolts, as stripped threads may result.
- This anti-sway bar is only warranted for the original installation. Installing a used anti-sway bar on another vehicle is not recommended and will void the warranty.

## WARNING

Failure to follow these instructions can result in property damage, personal injury or even death.

# PARTS LIST

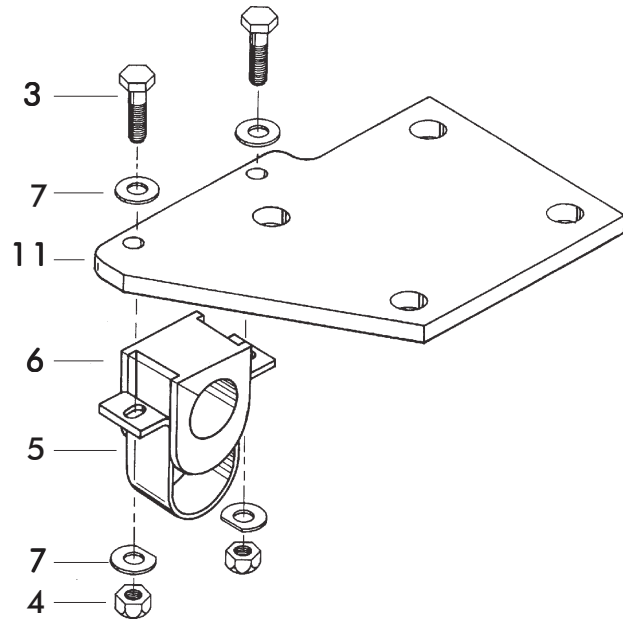
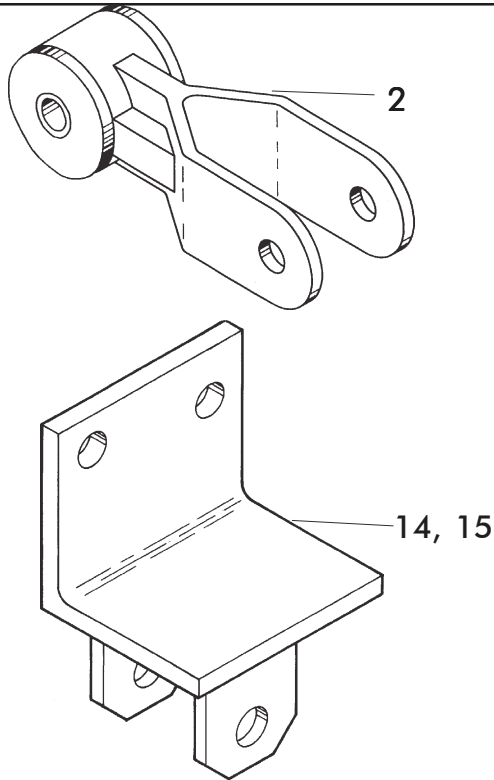

## Part #1209-101

| Part #       | Description                    | Qty |
|--------------|--------------------------------|-----|
| 1. 580092-00 | Anti-sway bar assembly, 1-1/2" | 1   |
| 2. B209      | Shackle assembly               | 2   |
| 3. 350074-00 | Bolt, 7/16" x 1-1/2"           | 4   |
| 4. 350256-02 | Loc-nut, 7/16"                 | 4   |
| 5. B141      | Bracket, U-clamp               | 2   |
| 6. 205217-10 | Bushing, split Poly            | 2   |
| 7. 350304-80 | Washer, 3/8"                   | 8   |
| 8. 350095-80 | Bolt, 1/2" x 1-3/4"            | 2   |
| 9. 350259-00 | Loc-nut, 1/2"                  | 2   |

\*not pictured

| Part #          | Description             | Qty |
|-----------------|-------------------------|-----|
| 10. 350308-20   | Washer, 1/2"            | 4   |
| 11. B273        | Bracket, flat           | 2   |
| 12. 350158-00   | Bolt, 5/8" x 3-1/2"     | 4   |
| 13. 350263-00   | Nut, 5/8"               | 4   |
| 14. B272L       | Bracket, end link, left | 1   |
| 15. B272R       | Bracket, end link right | 1   |
| 16. 40011-30    | AQUALUBE Grease         | 1   |
| 17. *205202-10  | Bushing                 | 4   |
| 18. *205-503-00 | Sleeve                  | 2   |

# INSTALLATION

The following instructions must be followed in the order listed to ensure a proper installation and to preserve the ROADMASTER warranty.

**1. Apply the parking brake.**

The following procedures can be done with the wheels of the vehicle on the ground.

**2. Locate the U-bolts holding the springs to the axle.**

Remove the nuts from the U-bolts. Retain the original bracket and add the flat plate (B273) with the small holes positioned toward the front and center of the vehicle. Secure with the original nuts and washers. Torque to the original manufacture's specifications.

**3. Locate the front leaf spring hanger bracket.**

In front of the leaf spring hanger bracket there is a bolt securing the rear cross member to the frame rails. Remove this bolt (Figure.1).

**4. Locate the provided end link hanger brackets.**

You can verify brackets left (B272L) and right (B272R) by the larger hole being in the rear position. Fasten with the original bolt, washer and nut. Torque to the factory specifications. Use the provided bolt (F338), washer (W421) and nut (N210) in the front hole. Tighten the bolt to 70 ft.-lbs.

**5. Install the saddle brackets and bushings on the anti-sway bar.**

Lubricate the inside of the split bushings with the provided lubricant (Figure.2). Install the bushings on the anti-sway bar near the arms. Slide the saddle brackets over the split bushings.

**6. Install the sway bar assembly to the flat plates.**

Lift the anti-sway bar assembly into position so that the saddle bracket holes align with the flat plate holes. Use the provided bolts (F387), washers (W407), and (N201) nuts to attach. Tighten to 50 ft.-lbs

**7. Locate the shackles and fasteners.**

Attach the shackles (B209) to the anti-sway bar end with the provided bolts (F352) and nuts (N223 — Figure.3). Do not tighten yet.

Figure 1

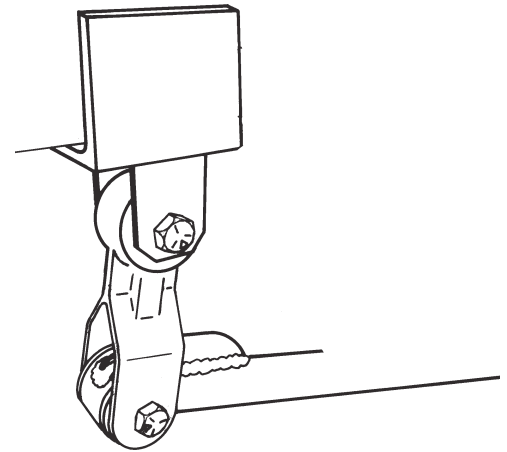

Figure 2

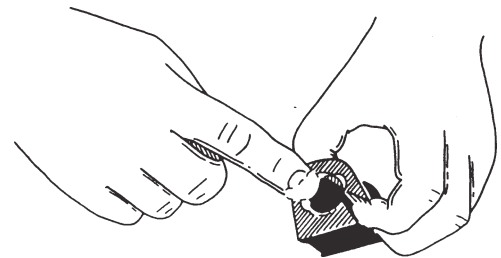
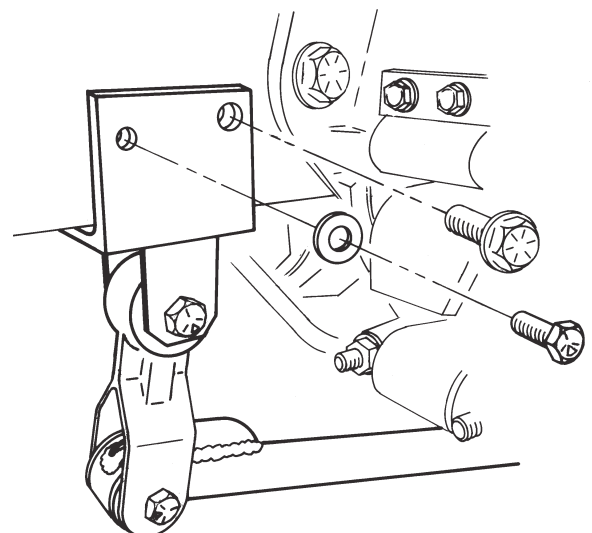

Figure 3



# INSTALLATION

The following instructions must be followed in the order listed to ensure a proper installation and to preserve the ROADMASTER warranty.

## 8. Rotate the anti-sway bar into position.

Swing the shackle up into the endlink bracket, using the provided bolts (F352) and nuts (N223). Tighten both the upper and lower bolts to 40-50 ft.-lbs. Re-check all the fasteners for the proper tightness.

## 9. Test drive and re-inspect the installation.

After road testing, re-check all fasteners for proper tightness.

### **WARNING**

After road testing, re-check all fasteners for proper tightness — if a fastener has worked loose or fallen off, re-tighten or replace it. Without all kit components properly tightened or in place, the anti-sway bar will not stabilize the vehicle at full capacity, which may cause reduced cornering ability or other reductions in vehicle handling or performance.

Failure to follow these instructions may result in property damage, personal injury or even death.

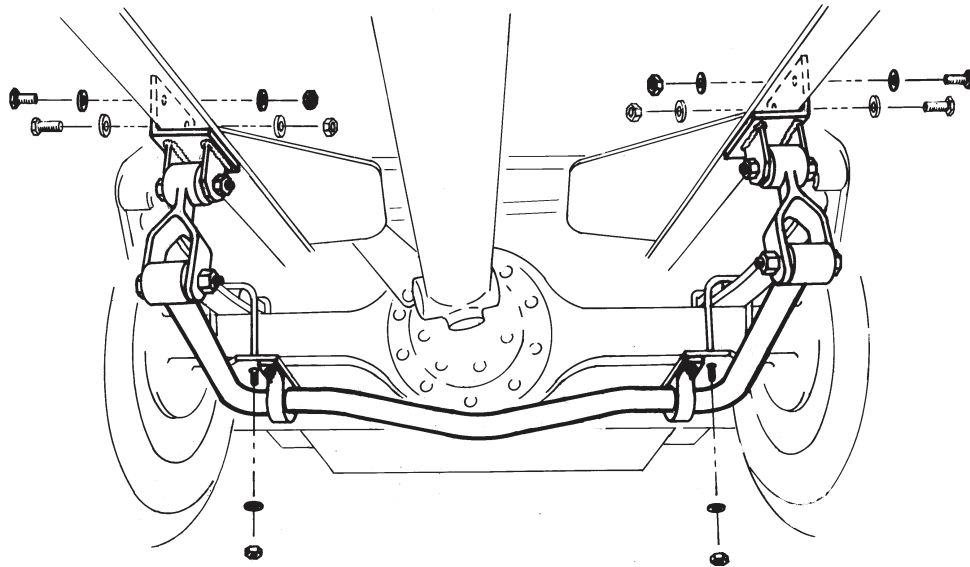

### **WARNING**

#### **The anti-sway bar is not a load-bearing component**

Do not tow or hoist the vehicle using the anti-sway bar or its mounting brackets as attachment points. The anti-sway bar is not designed to carry the weight of the vehicle and may collapse, which will damage the anti-sway bar components, the suspension, or other components. The vehicle will detach or fall, which may cause severe personal injury.

Failure to follow these instructions may result in property damage, personal injury or even death.